

PROJECT INFORMATION

LEGAL ADDRESS: LOT 6, OF LOT 121A, VICTORIA CITY PLAN 2871; LOT 9, OF LOT 121A, VICTORIA CITY PLAN 2871 EXCEPT THE NORTHERLY 24 FEET OF SAID LOT
CIVIC ADDRESS: 1007 GOVERNMENT STREET VICTORIA, B.C.

ZONING DATA
ZONING (EXISTING): CA-50, GOVERNMENT STREET LRS DISTRICT
ZONING (PROPOSED): INCLUDES CANNABIS RETAIL
SITE AREA: 128.95m² (1493.65 S.F.)
GROUND FLOOR AREA: 118.26 m² (1,273 S.F.)

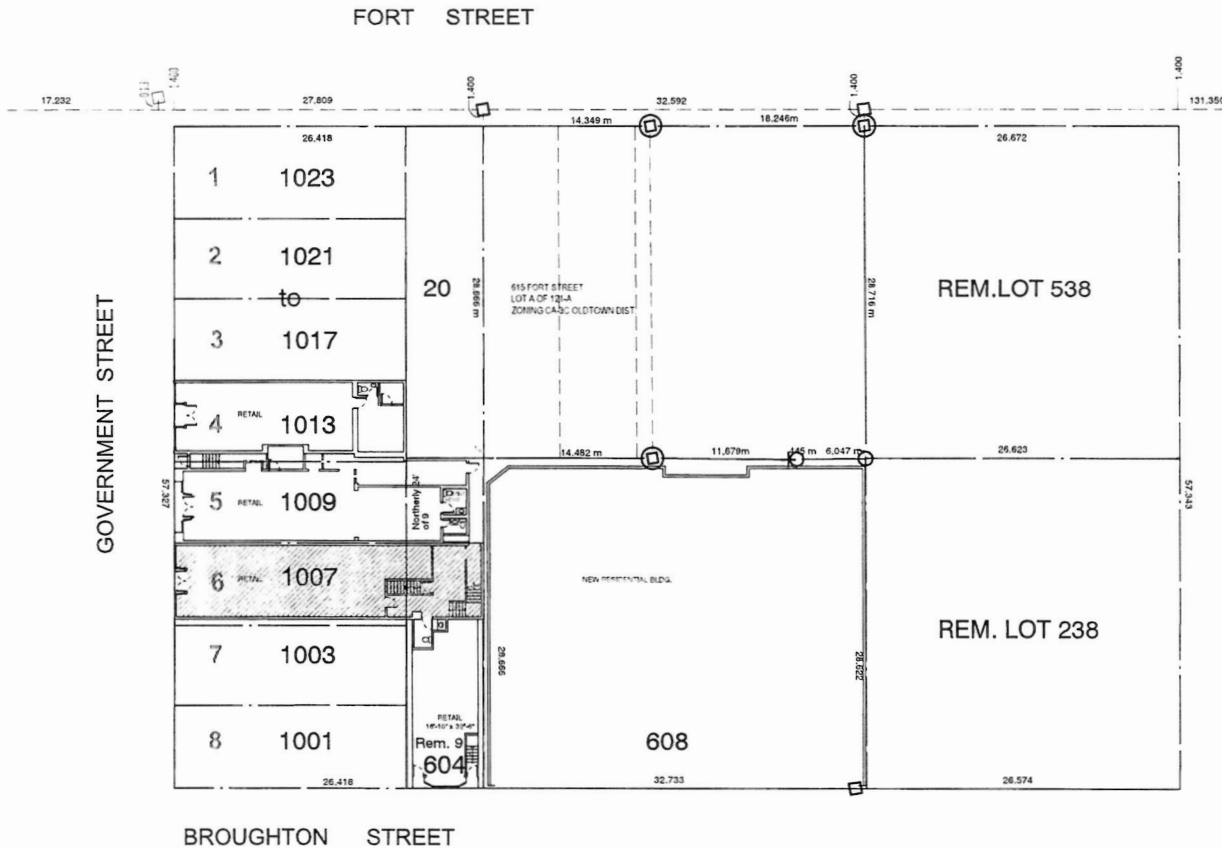

Professional Engineers' Terms and Conditions apply to the preparation of this plan. The Engineer's responsibility is limited to the information provided to the Engineer by the client.

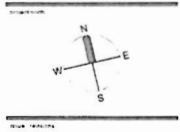

1	REZONING APPLICATION	15 JAN 18
No.	Issued	Permitted
Date		

alan lowe architect inc.
 101 - 1110 PROSPERITY ST
 VICTORIA, BC V8P 2C6
 TEL: 250-383-1111



GORDON STREET

Received
 City of Victoria
JAN 24 2018
 Planning & Development Department
 Community Planning Division

REZONING APPLICATION
 1007 GOVERNMENT STREET
 SITE CONTEXT PLAN

project no.	18-529
date	15 JANUARY 2018
scale	AS NOTED
author	LOWE
checker	AA

A1.0



2 ELEVATION
SCALE: 3/16" = 1'-0"

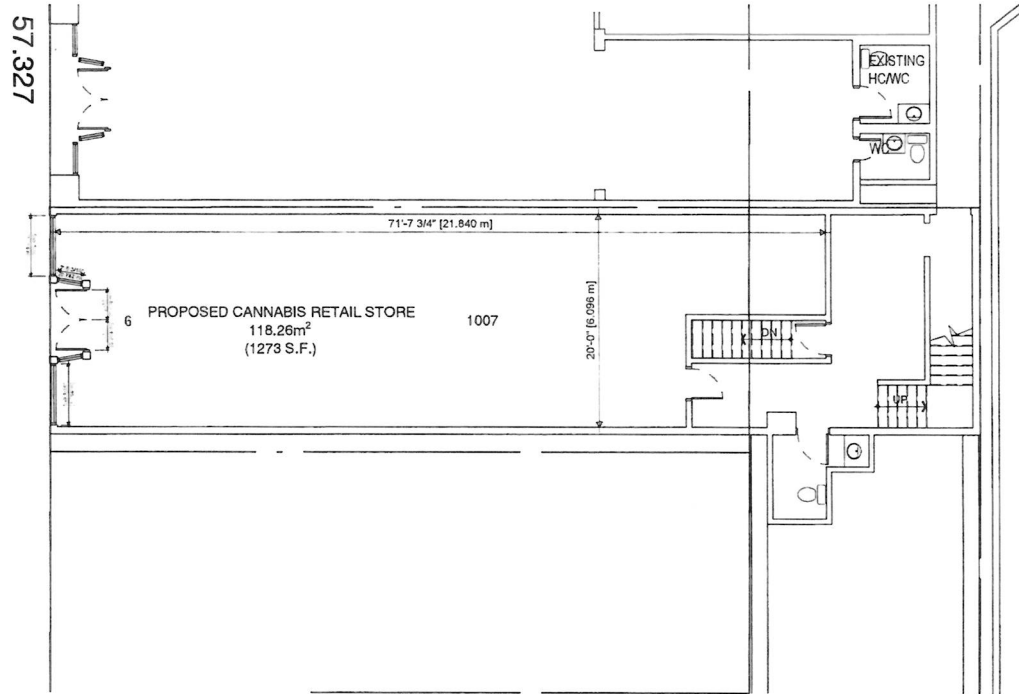

1 FLOOR PLAN
SCALE: 3/16" = 1'-0"

Received
City of Victoria
JAN 24 2018
Planning & Urban Form Department
Community Planning Division

Documents Received: These documents are not to be used for any other purpose without the written consent of the Architect or architect.

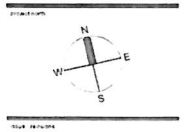

REVISIONS	
No.	Date
1	15 JAN 18

alan lowe architect inc.
203 - 1110 Pender Street E.
Victoria, British Columbia
V8A 2E6

REZONING APPLICATION
1007 GOVERNMENT STREET

project no.	18-529
date	15 JAN 18 11:11 AM
scale	AS NOTED
checked by	LOWE architects AA

A2.0



2 WALKING DISTANCE TO NEAREST CANNABIS RETAILER (350m)
 A3.0 SCALE 1:75



1 WALKING DISTANCE TO NEAREST SCHOOL (350m)
 A3.0 SCALE 1:75

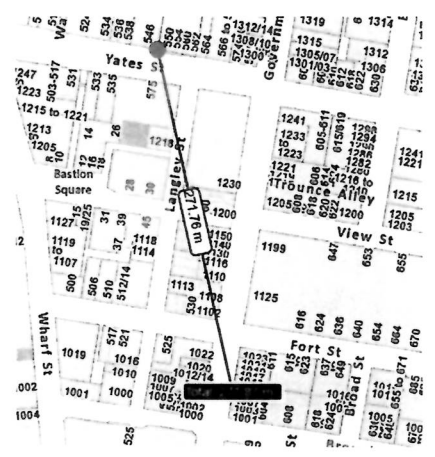
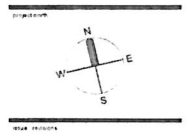

3 STRAIGHT LINE DISTANCE TO NEAREST CANNABIS RETAILER (271.87m)
 A3.0 SCALE 1:75

Received
 City of Victoria
 JAN 24 2018
 Planning & Development Department
 Community Planning Division

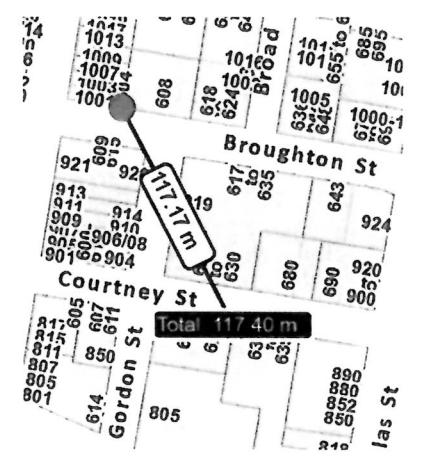

4 STRAIGHT LINE DISTANCE TO NEAREST LOT LINE OF SCHOOL (117.40m)
 A3.0 SCALE 1:75

1	PROPOSAL APPLICATION	16 JAN 2018
No.	Issue	Revised
Date		

alan lowe architect inc.
 103 - 1110 Glenora Street
 Victoria, South Australia
 3122

REZONING APPLICATION
 1107 GOVERNMENT STREET
 DISTANCES

project no.	18-529
date	15 JAN 2018 11:44 AM
author	LOWE alan m
checker	AA

A3.0