

Hi Folks,

Below are images with the changes we discussed today. There is also an option at the end of the document for a slightly different layout of the office and sorting area for consideration and feedback.

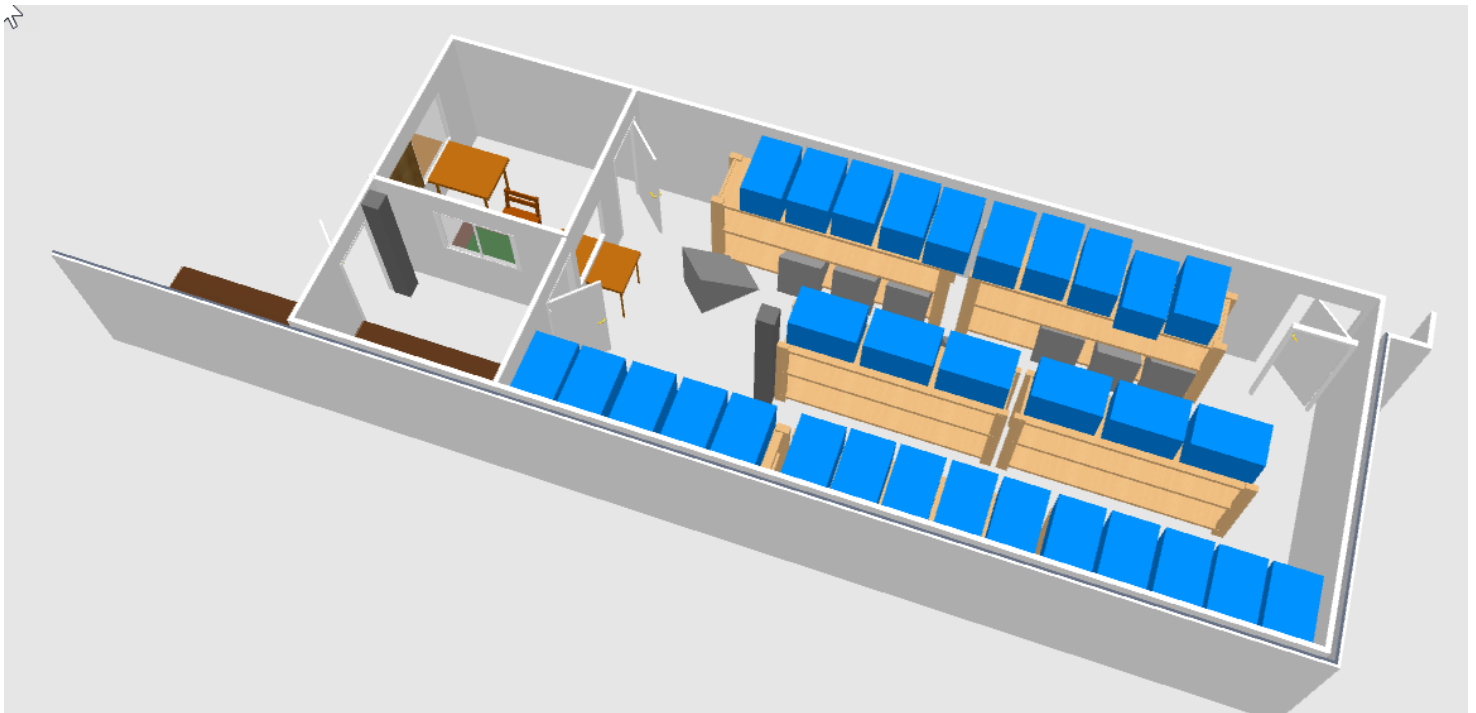

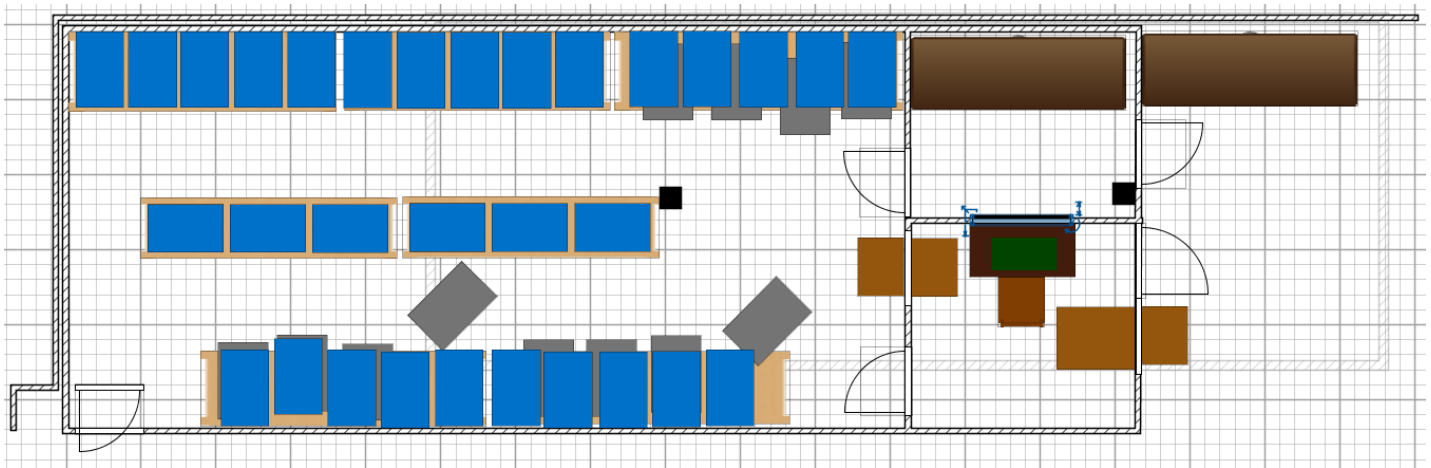
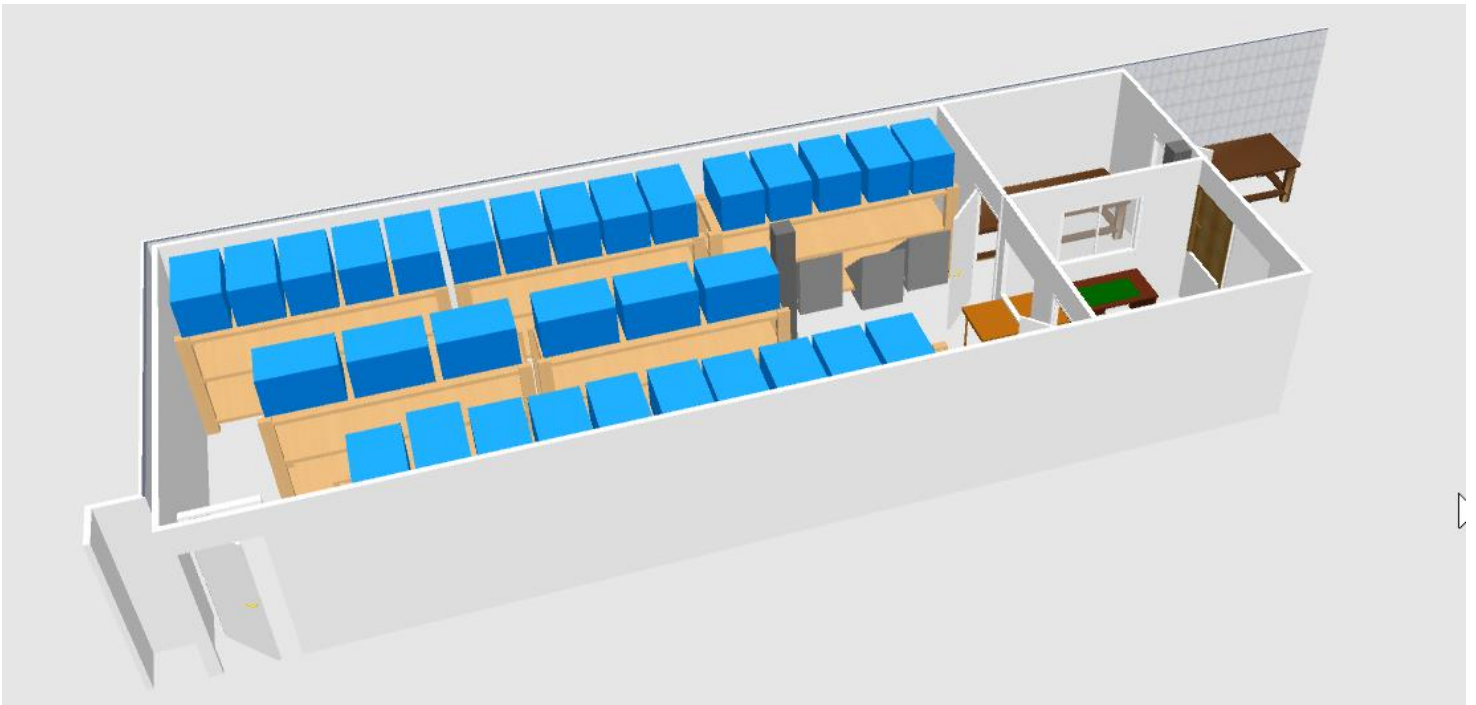

The image below has a rectangle that represents the current roof structure.



Close up of office to compare to options in next section of document



The 3 primary changes to the optional layout below are and each option can be implemented independently:

1. The pass through for the bin comes directly from/to the office,
2. The end wall has been moved 30 cm out further to accommodate a 345cm (11' 6") table
3. A door and window have been added to the office for outside viewing and access.



