

LCLB OFFICIAL PLAN
 MUST BE KEPT WITH LIQUOR LICENCE AND
 AVAILABLE FOR INSPECTION AT ALL TIMES
 Date Issued: July 12, 2012
 FP Licence # 303529

[Signature]
 General Manager

City of Victoria
 *Reviewed for Occupant Load Only

Maximum Occupant Load is:

Main Floor: 23 Persons

Mezzanine: 11 Persons

Ratio Deck: 1 Person

Total: 34 Persons

Building Official:

Name: *[Signature]*
 Signature: *[Signature]*
 Date: July 6, 2012

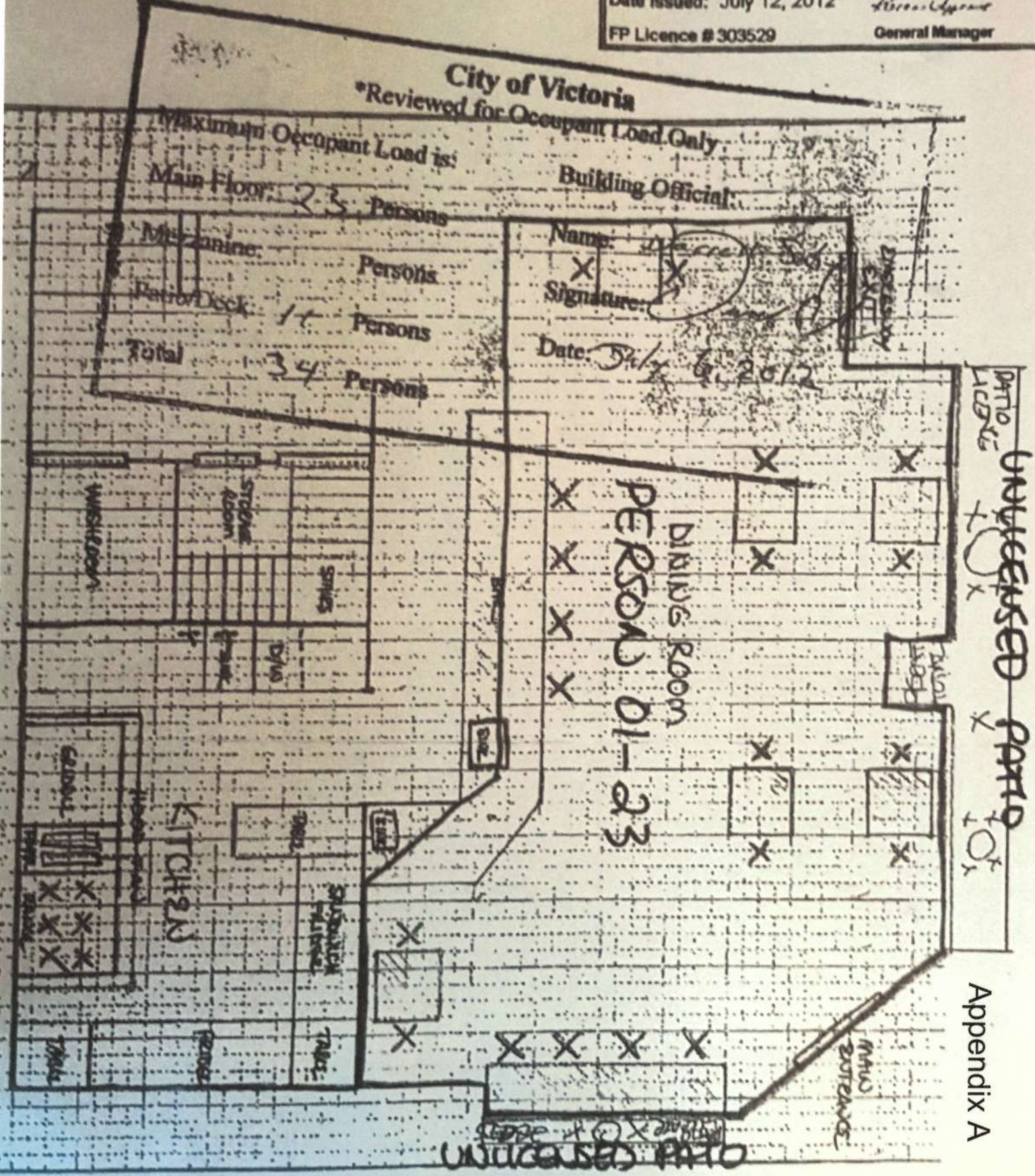

Appendix A

1002 BLANSHARD ST

CLARKE & CO.

SIDEWALK BAR FOR

Appendix A

PLAN VIEW

SCALE 1/4" = 1'

MAY 29 2017

MAIN
ENTRANCE

For Person 01 see other plan

SERVICE
ENTRANCE

WINDOWS

Patio 1 = 9 persons

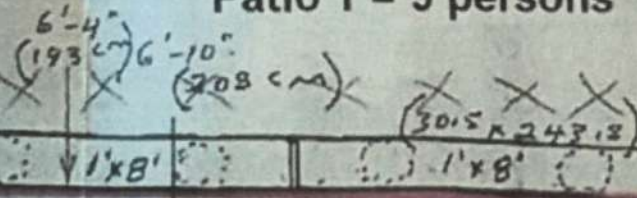

5' (152.4 cm)
5'

86.36 x 121.92

ACCESS
GRATES

86.36 x 182.88

LCLB OFFICIAL PLAN
MUST BE KEPT WITH LIQUOR LICENCE
AND AVAILABLE FOR INSPECTION AT ALL TIMES
Date issued: August 25, 2017

Licence #: 303529

General Manager

LIQUOR CONTROL AND LICENSING BRANCH
FLOOR PLANS - APPROVAL IN PRINCIPLE

DATE August 17, 2017

LICENSING
ADMINISTRATOR

Maximum Capacity: Person 01-23 Patio 01-08

Unless otherwise approved by the General Manager, Liquor Control and Licensing, approval is subject to the terms and/or conditions of specified in the approval letter(s) dated:

PSA PCA AIP

EDGE OF SIDE WALK

PAGE 1 OF 2

BLANSHARD STREET

BROUGHTON STREET

City of Victoria - Fire Department Occupier Load Reviewed Under Current BC Fire Code Only			
Maximum Occupant Load in Main Floor:	Persons	Persons	Persons
Mezzanine:	Persons	Persons	Persons
Patio/Deck:	9	9	9
Total:	9	9	9
Signature:	Date: AUG 16/17		
Name: M. S. S. S.			

LIGHT
POST

GARBAGE
CAN

0 chairs 2' x 2'
8 total