

NO. 21-072

# A BYLAW OF THE CITY OF VICTORIA

The purposes of this Bylaw are to amend the Zoning Regulation Bylaw by amending the GWP Zone, Gorge Waterway Park District to allow for public docks, wharfs and piers.

The Council of The Corporation of the City of Victoria enacts the following provisions:

- 1 This Bylaw may be cited as the “ZONING REGULATION BYLAW, AMENDMENT BYLAW  
(NO. 1258)”.
- 2 Schedule B of the Zoning Regulation Bylaw is amended by replacing Part 9.3 with the  
provisions contained in Schedule 1 of this Bylaw.

READ A FIRST TIME the day of 2021

READ A SECOND TIME the \_\_\_\_\_ day of \_\_\_\_\_ 2021

Public hearing held on the \_\_\_\_\_ day of \_\_\_\_\_ 2021

READ A THIRD TIME the \_\_\_\_\_ day of \_\_\_\_\_ 2021

ADOPTED on the \_\_\_\_\_ day of \_\_\_\_\_ 2021

CITY CLERK

MAYOR

## PART 9.3 – GWP ZONE, GORGE WATERWAY PARK DISTRICT

### 9.3.1 Permitted Uses in this Zone

The following uses are the only uses permitted in this Zone:

- a. Parks and uses accessory to parks, including public docks, wharfs, and piers
- b. Water related recreational activities

Without limiting the generality of any Section or Part of the Zoning Regulation Bylaw, including Section 17 of the Introduction and General Regulations, the following uses are not permitted in this Zone

- i. The anchoring or mooring of vessels for a continuous period exceeding 48 hours
- ii. The anchoring or mooring of vessels for more than 72 hours within a 30-day period
- iii. Live-aboard or float home as defined in Part 7.54.1 in the FWM zone, Fisherman's Wharf Marine District
- iv. Docks, wharfs and piers except as accessory park use

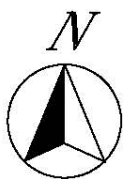
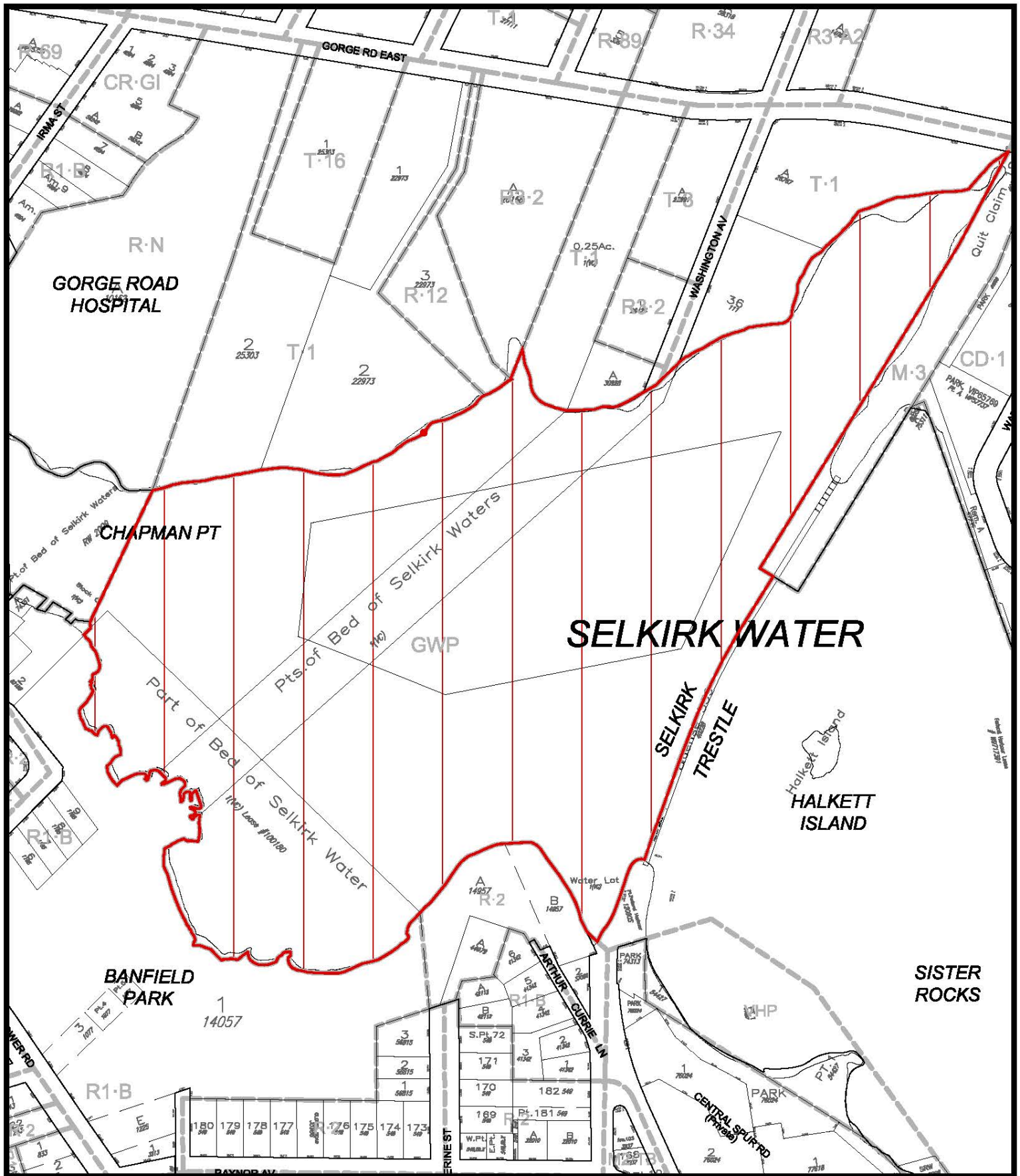

Public Docks within Gorge Waterway Park  
Rezoning No.00785

