

K.3 Bylaw for Gorge Waterway Park District

Moved By Councillor Isitt

Seconded By Councillor Loveday

That the following bylaw **be given first and second readings:**

- Zoning Regulation Bylaw, Amendment Bylaw (No. 1258), No. 21-072

CARRIED UNANIMOUSLY

DRAFT



**Council Report
For the Meeting of July 15, 2021**

To: Council **Date:** July 8, 2021
From: C. Kingsley, City Clerk
Subject: Gorge Waterway Park: Rezoning Application No. 00785

RECOMMENDATION

That the following bylaw be given first and second readings:

1. Zoning Regulation Bylaw, Amendment Bylaw (No. 1258) No. 21-072

BACKGROUND

Attached for Council's initial consideration is a copy of the proposed Bylaw No. 21-072.

The issue will come before Council on July 15, 2021 where the following resolution is to be considered:

Rezoning Application No. 00785 for Gorge Waterway Park

1. That first and second reading of the Zoning Regulation Bylaw Amendment outlined in Rezoning Application No. 00785 for Gorge Waterway Park be considered by Council and a Public Hearing date be set.
2. That Council advance this matter for ratification at the July 15, 2021 daytime Council meeting and proceed with giving the bylaws introductory readings at this same meeting so that a Public Hearing can be scheduled for August 5, 2021.

Respectfully submitted,

Curt Kingsley
City Clerk

Report accepted and recommended by the City Manager

List of Attachments:

- Bylaw No. 21-072

PART 9.3 – GWP ZONE, GORGE WATERWAY PARK DISTRICT

9.3.1 Permitted Uses in this Zone

The following uses are the only uses permitted in this Zone:

- a. Parks and uses accessory to parks, including public docks, wharfs, and piers
- b. Water related recreational activities

Without limiting the generality of any Section or Part of the Zoning Regulation Bylaw, including Section 17 of the Introduction and General Regulations, the following uses are not permitted in this Zone

- i. The anchoring or mooring of vessels for a continuous period exceeding 48 hours
- ii. The anchoring or mooring of vessels for more than 72 hours within a 30-day period
- iii. Live-aboard or float home as defined in Part 7.54.1 in the FWM zone, Fisherman's Wharf Marine District
- iv. Docks, wharfs and piers except as accessory park use

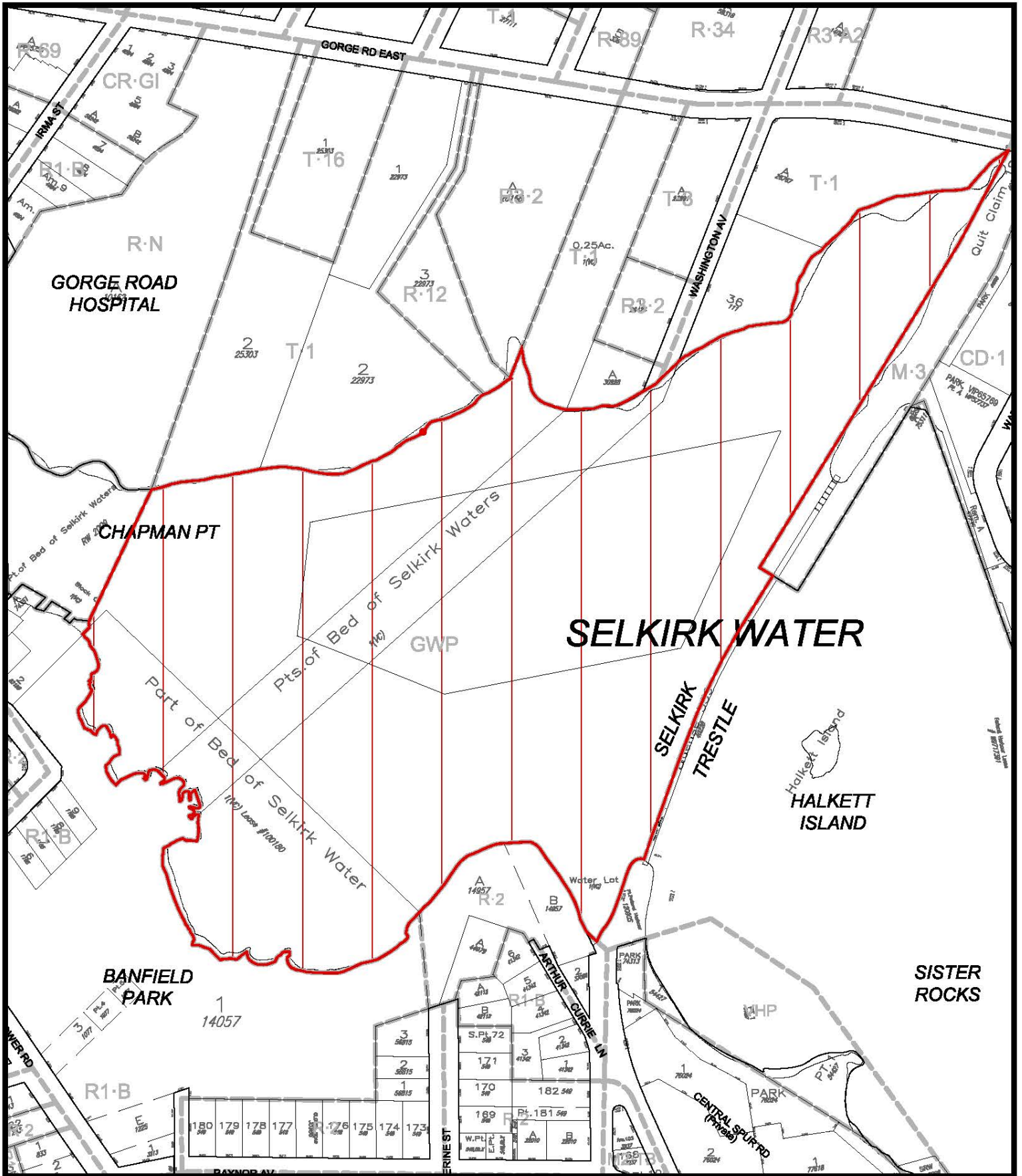

Public Docks within Gorge Waterway Park
Rezoning No.00785

