

March 1, 2019

Liquor and Cannabis Regulation Branch

PO Box 9292 Stn Prov Govt

Victoria BC V8W 9J8

1-250-952-7049

LCLBHelpDesk@gov.bc.ca

To whom it may concern;

We welcome the opportunity to submit this letter of intent ("LOI") to the Liquor and Cannabis Regulation Branch along with the application for Liquor Primary License ("LPL") on behalf of the Victoria International Marina ("VIM").

1. Primary Focus

The primary focus of business at VIM is marina moorage, marina club space rental, and captain and crew facilities.

2. Hours of Operations

Operating hours are typically 9am to 5pm 7 days a week; However, the application will be from 9am-10pm Sunday to Thursday and 9am-11pm Friday and Saturday as there are functions that are held in the marina building at varying hours.

3. Entertainment

Types of entertainment will vary pending type of function being held. We will allow for live music, dance floor, DJ booth and TV. There will be no gambling, exotic dancing or anything of that type.

4. Food Service

Full food service is not something VIM will offer. If there are private functions, outside catering will be hired; however, VIM will provide hot and cold snacks as well as non-alcoholic beverages during hours of operation.

5. Neighbourhood

The surrounding neighbourhood is a mix of retail and residential. We are a stand along building, our development has another stand alone building which is a restaurant. Across the street is a residential building.

6. Noise

Noise will be limited as VIM has engineered soundproofing in the building it self and does not have outdoor sitting areas. VIM will also remind guests to keep noise to a minimum when entering and exiting the building.

7. Measures implemented

The measures VIM will implement to assure noise is kept to a minimum for nearby residents are to keep music to reasonable volume as the night goes on, remind guests verbally and with signage.

8. Additional License/ Endorsements

VIM will also be requesting to have minors in the service areas, as alcohol is not the primary focus of the establishment. VIM is primarily a yacht moorage facility and club space, thus will have people of all ages through out the property.

The Victoria International Marina is looking forward to proceeding together with the Liquor and Cannabis Regulation Branch on this application.



Steve Sinclair
Director of Operations
steve@vimarina.ca
250-896-7600

CITY SIDEWALK

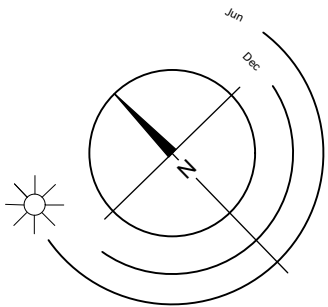
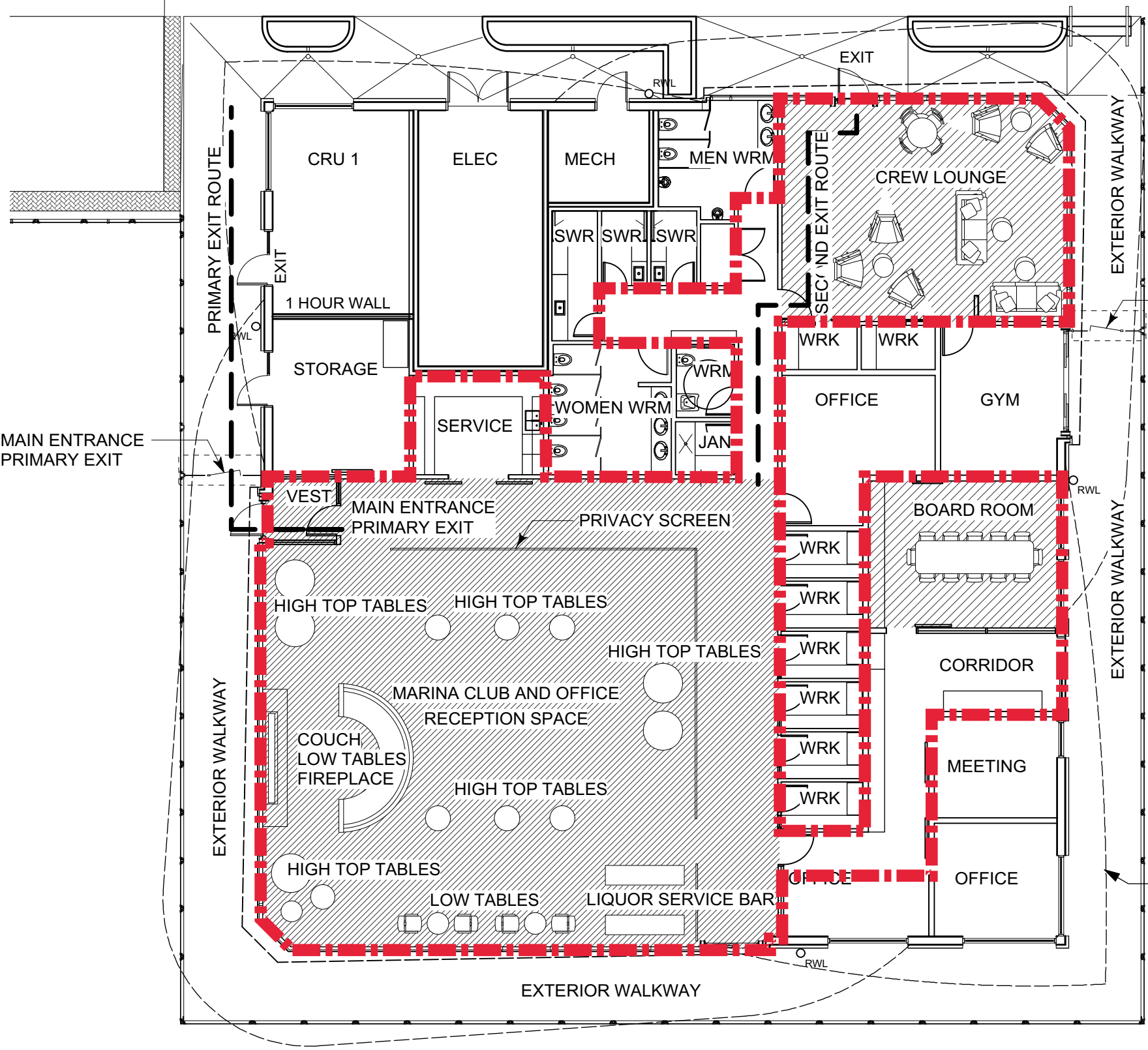

0 2 500 5 000mm
1 : 150

Indicates Licensed Areas

Waterclosets Provided:
4 - Female
4 - Male
1 - Universal

Occupant Load Permitted to BCBC 3.7.2.2 is 260 people.

Occupant Load Calculation:
Based on BCBC 3.7.2.2 is 260 patrons plus staff.
Marina Club and Office Reception Space - 200 people.
Crew Lounge - 48 people
Boardroom - 12 people

MAIN ENTRANCE
PRIMARY EXIT

EXIT DOOR

Extend of roof above

CITY SIDEWALK

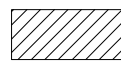
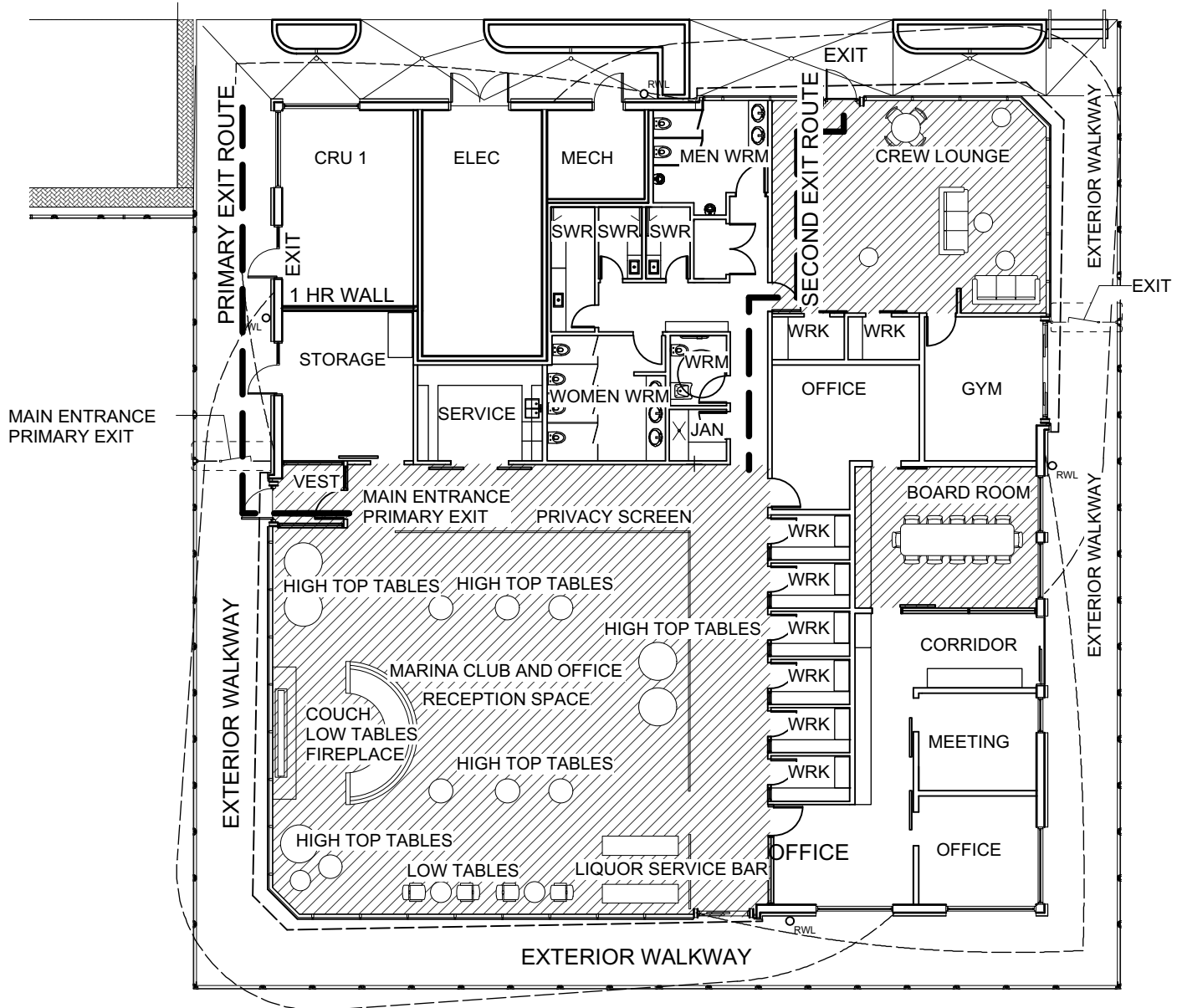

Indicates Licensed Areas

Waterclosets Provided:

- 4 - Female
- 4 - Male
- 1 - Universal

Occupant Load Permitted to BCBC 3.7.2.2 is 260 people.

Occupant Load Calculation:

Based on BCBC 3.7.2.2 is 260 patrons plus staff.

Marina Club and Office Reception Space - 200 people.

Crew Lounge - 48 people

Boardroom - 12 people

