

A BYLAW OF THE CITY OF VICTORIA

The purposes of this Bylaw are to amend the Zoning Regulation Bylaw to establish accessible parking regulations by adding definitions in Schedule A – Definitions and adding a new section to Schedule C – Off-Street Parking.

Contents

- 1 Title
- 2 Amendments
- 3 Transition Provision
- 4 Commencement

The Council of The Corporation of the City of Victoria in an open meeting assembled enacts the following provisions:

Title

- 1 This Bylaw may be cited as the “ZONING REGULATION BYLAW 22-024, AMENDMENT BYLAW (NO. 1260)”.

Amendments

- 2 Bylaw No. 80-159, the Zoning Regulation Bylaw, is amended as follows:
 - (a) in Schedule A - Definitions:
 - (i) by adding the following definition immediately before the definition of **“Accessory Building”**:

“**“Accessible Parking Space”** means a parking space designed and installed in accordance with the specifications and dimensions in section 4.2 and Figure 4 of Schedule C – Off-Street Parking Regulations.”;
 - (ii) by adding the following definition immediately after the definition of **“Unobstructed Access”**:

“**“Van Accessible Parking Space”** means a parking space designed and installed in accordance with the specifications and dimensions in section 4.2 and Figure 5 of Schedule C – Off-Street Parking Regulations.”
 - (b) in Schedule C – Off-Street Parking Regulations, by adding:
 - (i) the following immediately after section 1.1.6:

“7. Where a variance has been granted to reduce the required number of off-street parking spaces, the number of parking spaces required by section 1.2 of this Schedule shall be used to calculate the required number of accessible parking spaces or van accessible parking spaces.”;
 - (ii) a comma and the word “slip-resistant” immediately after the word “durable” in section 2.1.1; and

SCHEDULE 1

4. Accessible Parking

4.1 Required Accessible Parking Spaces

1. The owner or occupier of any land or any building or other structure, for each use listed in Table 5 present on the land or in the building or other structure, must provide the corresponding minimum number of off-street accessible parking spaces and van accessible parking spaces in accordance with Table 5. For example, if an owner is required to provide 27 vehicle parking spaces for a commercial use pursuant to Table 1, the owner must provide 1 accessible parking space, 1 van accessible parking space and 25 vehicle parking spaces.

Table 5: Minimum Number of Required Accessible Parking Spaces and Van Accessible Parking Spaces

Use or Class of Use:		
<u>Attached Dwelling, Multiple Dwelling</u>		
All commercial uses listed in Table 1		
All institutional uses listed in Table 1 except <u>hospital</u> (see below)		
All industrial uses listed in Table 1		
Number of Parking Spaces Required per Table 1	Minimum Number of <u>Accessible Parking Spaces</u>	Minimum Number of <u>Van Accessible Parking Spaces</u>
0-5 spaces	n/a	n/a
6-25 spaces	0	1
26-50 spaces	1	1
51-75 spaces	2	1
76-100 spaces	3	1
101 spaces or more	1 <u>accessible parking space</u> for every 25 parking spaces	See section 4.1.2
Number of Visitor Parking Spaces Required per Table 1	Minimum Number of <u>Visitor Accessible Parking Spaces</u>	Minimum Number of <u>Visitor Van Accessible Parking Spaces</u>
0-5 spaces	n/a	n/a
6-25 spaces	0	1
26-50 spaces	1	1
51-75 spaces	2	1
76-100 spaces	3	1
101 spaces or more	1 <u>accessible parking space</u> for every 25 parking spaces	See section 4.1.2
Use or Class of Use:		
<u>Assisted Living Facility (as defined in Table 1)</u>		
Number of Parking Spaces Required per Table 1	Minimum Number of <u>Accessible Parking Spaces</u>	Minimum Number of <u>Van Accessible Parking Spaces</u>
See Table 1	15% of required vehicle parking spaces	See section 4.1.2

Number of Visitor Parking Spaces Required per Table 1	Minimum Number of Visitor <u>Accessible</u> Parking Spaces	Minimum Number of Visitor <u>Van Accessible</u> Parking Spaces
See Table 1	15% of required vehicle parking spaces	See section 4.1.2
Use or Class of Use: <u>Hospital</u>		
Number of Parking Spaces Required per Table 1	Minimum Number of <u>Accessible</u> Parking Spaces	Minimum Number of <u>Van Accessible</u> Parking Spaces
See Table 1	5% of required vehicle parking spaces	See section 4.1.2
Number of Visitor Parking Spaces Required per Table 1	Minimum Number of Visitor <u>Accessible</u> Parking Spaces	Minimum Number of Visitor <u>Van Accessible</u> Parking Spaces
See Table 1	5% of required vehicle parking spaces	See section 4.1.2

2. Where:

- (a) only one accessible parking space is required, the space must be a van accessible parking space;
- (b) between two and six accessible parking spaces are required, a minimum of one of these spaces must be a van accessible space;
- (c) more than six accessible parking spaces are required, the requirement for a van accessible space is triggered at each multiple of six accessible parking spaces, for example:
 - i. where 7-12 accessible parking spaces are required, a minimum of two of these spaces must be van accessible spaces;
 - ii. where 13-18 accessible parking spaces are required, a minimum of three of these spaces must be van accessible spaces;
 - iii. where 19-25 accessible parking spaces are required, a minimum of four of these spaces must be van accessible spaces.

4.2 Accessible Parking Dimensions and Specifications

1. All accessible parking spaces and van accessible parking spaces required under this Bylaw must be provided on the same lot as the building or use which they serve.
2. Accessible parking spaces and van accessible parking spaces must have a maximum grade of 5% in any direction.
3. Each accessible parking space required under this Bylaw must be designed, marked, and installed to the minimum dimensions and specifications in accordance with the applicable configuration shown in Figure 4 of this Schedule.

Figure 4: Minimum accessible parking space dimensions

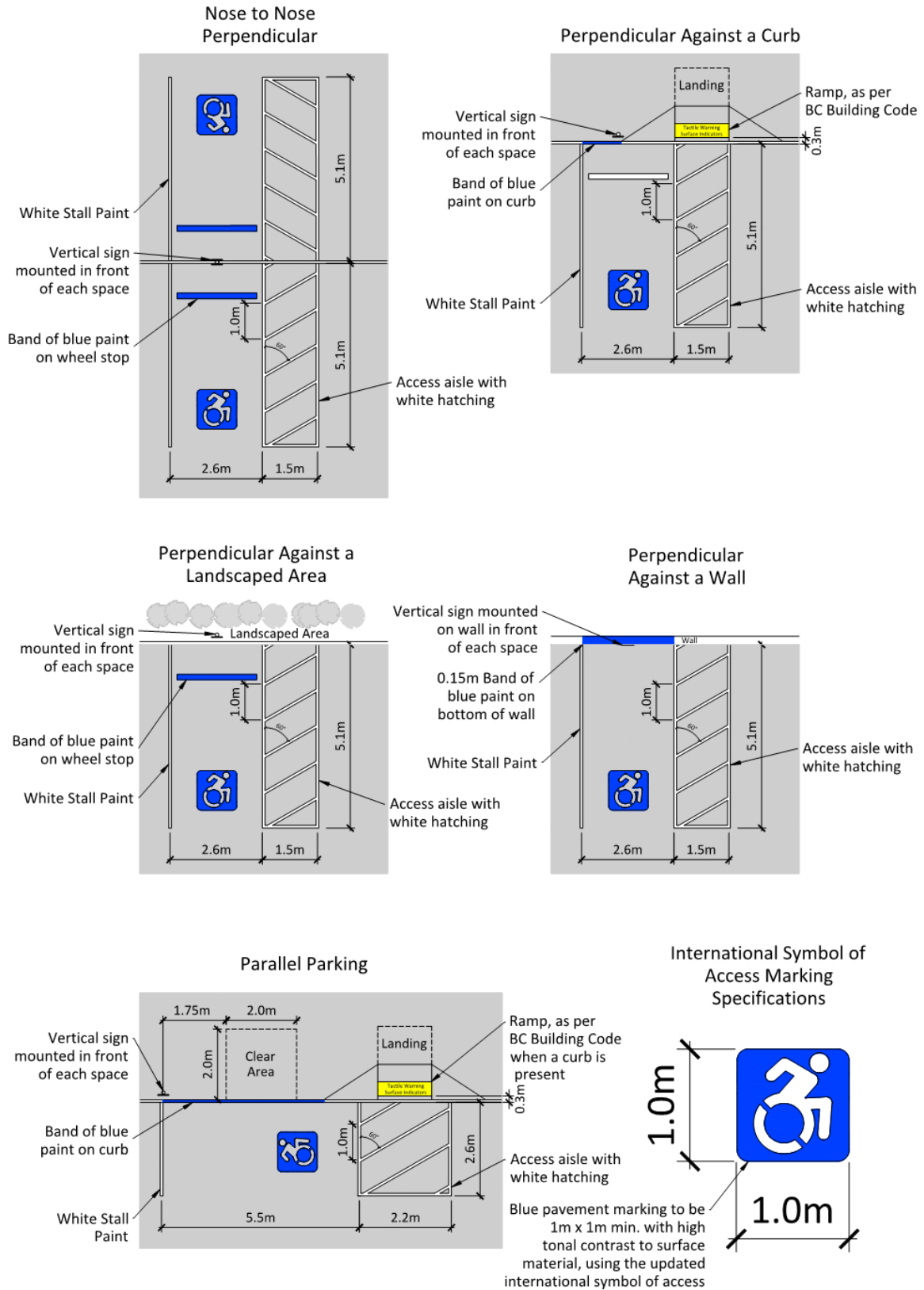

4. Each van accessible parking space required under this Bylaw must be designed, marked, and installed to the minimum dimensions and specifications in accordance with the applicable configuration shown in Figure 5 of this Schedule.

Figure 5 Minimum van accessible parking space dimensions

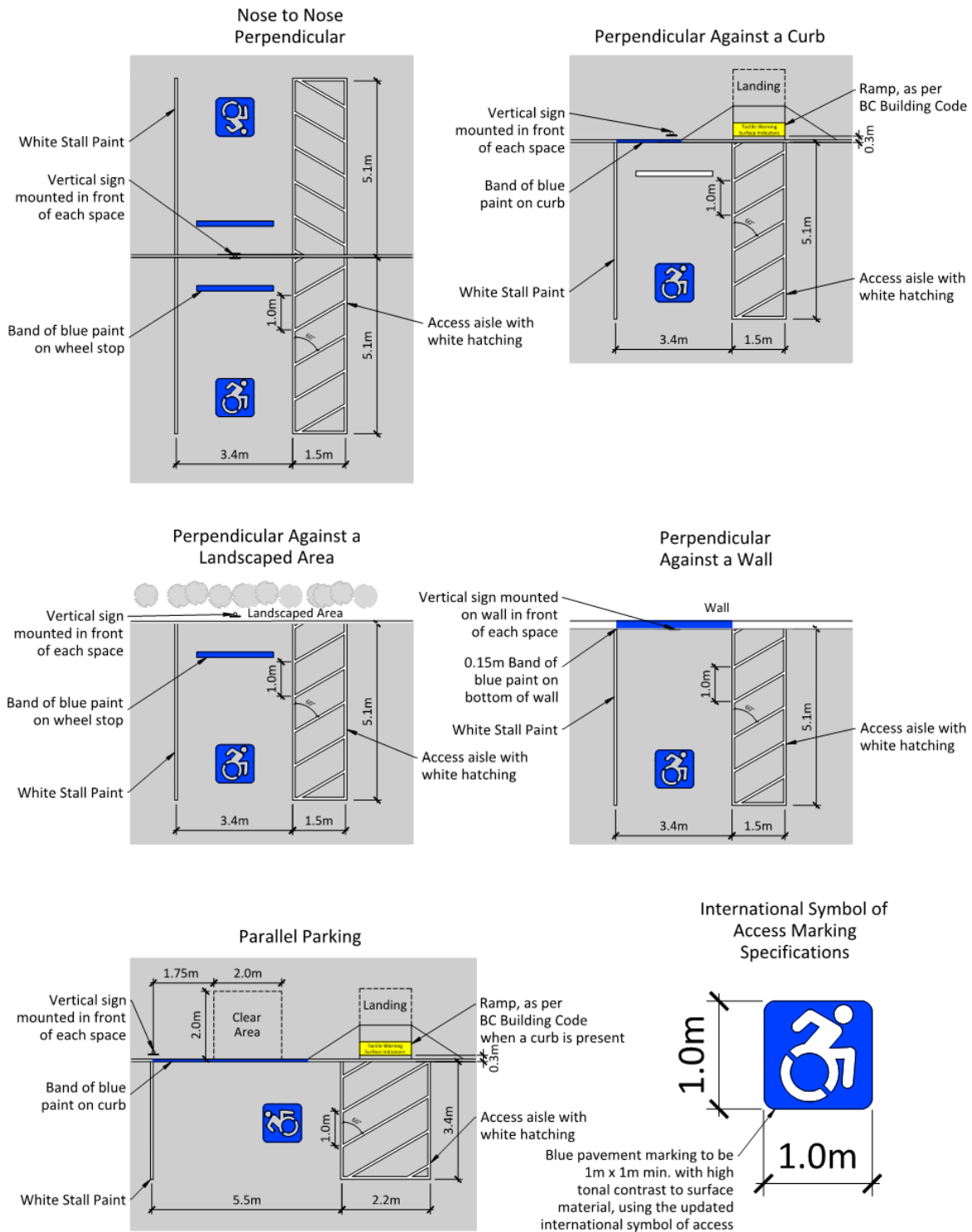

5. An access aisle must be included with each accessible parking space with the specifications and minimum dimensions shown in Figure 4 and with each van accessible space with the specifications and minimum dimensions shown in Figure 5.
6. Where an accessible parking space or van accessible parking space is situated immediately adjacent to another accessible parking space or van accessible parking space, then the access aisle may be shared between the two spaces.
7. Each accessible parking space or van accessible parking space must be marked with the International Symbol of Access in accordance with the dimensions and specifications illustrated in Figures 4 and 5.
8. A wall mounted or standalone vertical sign must be installed at each accessible parking space or van accessible parking space in accordance with the specifications illustrated in Figure 6 and the lowest part of the sign must be located:
 - (a) a minimum of 2.1m above finished grade, or
 - (b) a minimum of 1.5m above finished grade when wall mounted or when the roof height of a parkade, carport or similar building or structure in which the associated parking space is located prevents compliance with subsection (a).

Figure 6: Accessible parking sign specifications

