

PART 9.6 – AGH Zone, Abkhazi Garden Heritage District**9.6.1 Permitted Uses in this Zone**

The following uses are the only uses permitted in this Zone:

- a. Recreational garden, which may include the following accessory uses:
 - i. Restaurant
 - ii. Retail sales
- b. Accessory Buildings subject to the regulations in Schedule “F”
- c. Notwithstanding paragraphs a. and b., the only use permitted on a lot with a lot area less than 5664.60m² is an accessory building

9.6.2 Floor Area, Floor Space Ratio

- | | |
|---------------------------------------|--------|
| a. <u>Floor space ratio</u> (maximum) | 0.04:1 |
|---------------------------------------|--------|

9.6.3 Height

- | | |
|-----------------------------|------|
| a. <u>Storeys</u> (maximum) | 1.00 |
|-----------------------------|------|

9.6.4 Setbacks

- | | |
|----------------------------------------------|--------|
| a. <u>Front yard setback</u> (minimum) | 41.00m |
| b. <u>Rear yard setback</u> (minimum) | 49.00m |
| c. <u>Side yard setback</u> (east) (minimum) | 10.00m |
| d. <u>Side yard setback</u> (west) (minimum) | 25.00m |

9.6.5 Site Coverage

- | | |
|-----------------------------------|-------|
| a. <u>Site Coverage</u> (maximum) | 3.50% |
|-----------------------------------|-------|

9.6.6 Vehicle and Bicycle Parking

- | | |
|-------------------------------------------------------------------------------------------------------|----------------------------------------------------------------------------------------------------------|
| a. Vehicle parking | Subject to the regulations in Schedule “C” except as otherwise specified by the regulations in this Part |
| b. Bicycle parking (minimum) | Subject to the regulations in Schedule “C” |
| c. Notwithstanding Section 1.2(1) of Schedule “C”, no off-street vehicle parking spaces are required. | |

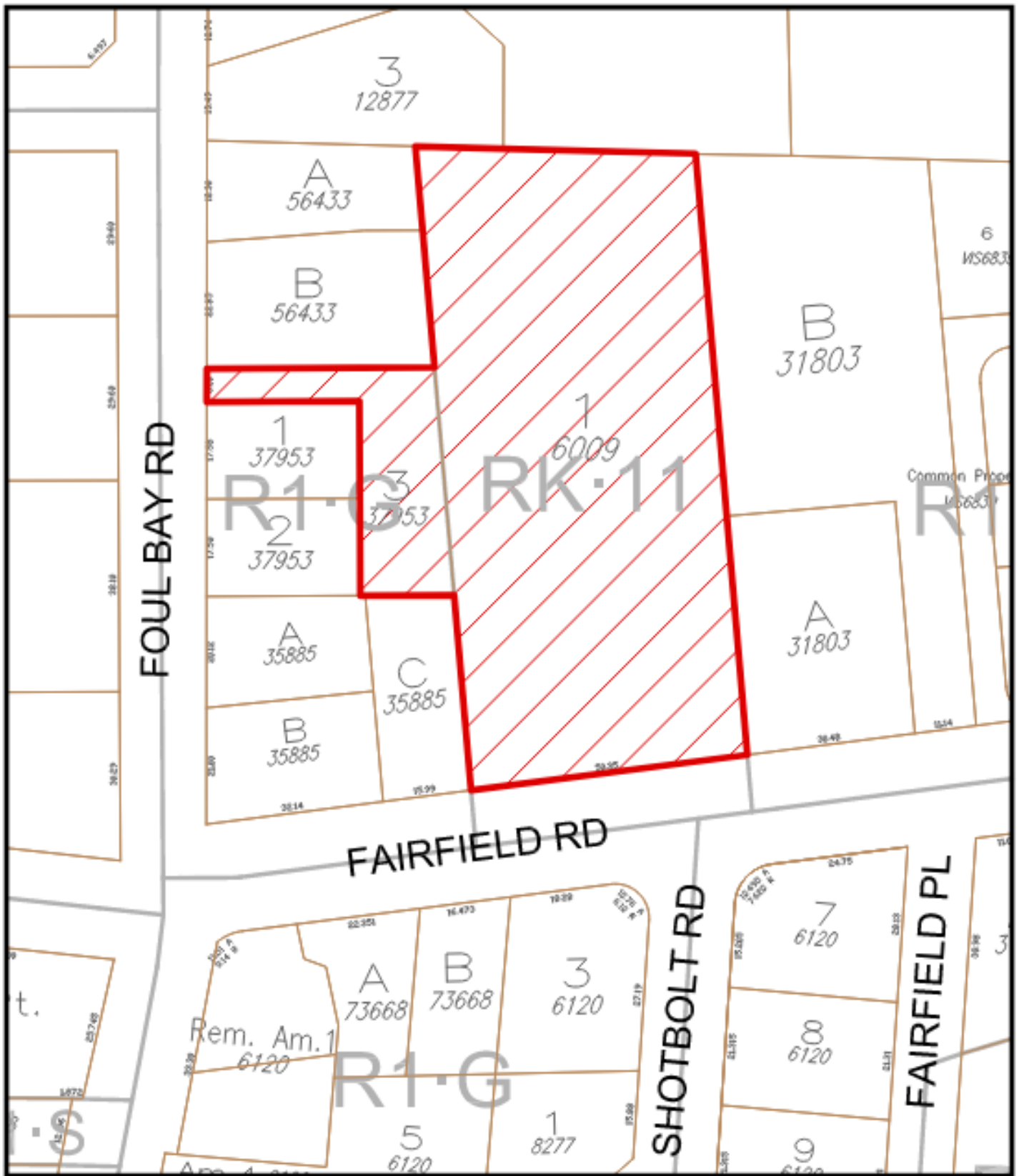

1964 Fairfield Road & 507 Foul Bay Road
Rezoning No.00845

