

Quadra Heights Playground Improvements

Governance and Priorities Committee: June 4, 2015



Report Purpose

- To present the results of the public engagement and to outline the proposed improvements for Quadra Heights Park playground and park renewal project



About Quadra Heights Park



About Quadra Heights Park

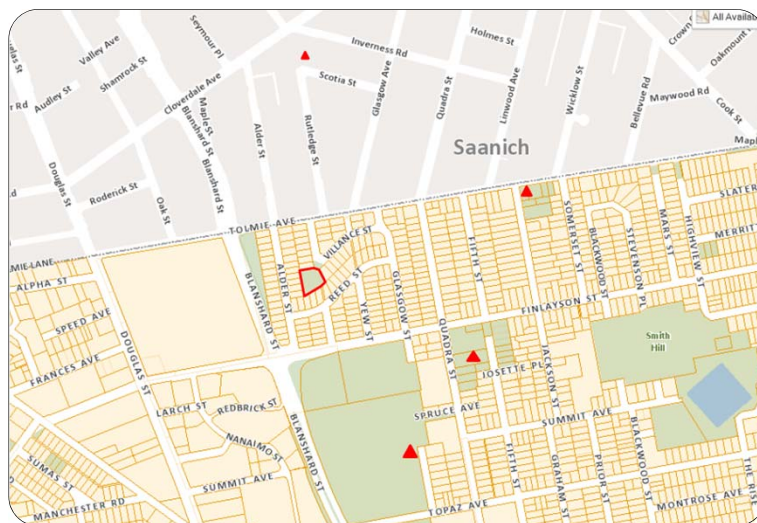

About Quadra Heights Park



Existing Play Features



- Current play equipment was installed in 1999 and includes:
 - Swings
 - Play structure
 - Merry-go-round



Engagement Highlights

Two open houses at the park



Engagement Highlights



- Feedback from children was encouraged through an interactive craft station where they could build or draw their future playground



Engagement Highlights

On-site ideas board



Quadra Heights Park Improvements



This year the City of Victoria is upgrading the playground at Quadra Heights Park. Tell us what equipment and improvements you would most enjoy.

This survey will take approximately 5 - 7 minutes to complete.

Please note that information you provide in your answers will form part of the public record for this project. In your answers, please do not provide any personal information you do not wish to share publicly such as your name or contact information.



Engagement Highlights

We want to hear from you!

The City of Victoria is upgrading the playground at Quadra Heights Park at the corner of Rutledge Street and Villance Street.

Tell us what equipment and improvements you would most enjoy.

Share your ideas before May 12:

- Visit the park and share your thoughts on the ideas board.
- Stop by an open house in the park:
 - Saturday, May 2, 1 – 3 p.m.
 - Wednesday, May 6, 4 – 6 p.m.

Fill in the survey:
haveyoursayvictoria.com
Tweet your ideas to #vicparks
Email: parks@victoria.ca
Call: 250.361.0600

You added 6 new photos.
 Posted by Malinda Jolley (1) · 2 hrs · 4k

Share your ideas about what new playground equipment you'd like to see at Quadra Heights Park. Drop by the park and write your thoughts on the Ideas Board, visit the open house at the park this Saturday 1-3 or fill in a short survey: www.haveyoursayvictoria.com

What other new play equipment

Picnic benches more

Bigger slide, The swing or the car

579 people reached

Like · Comment · Share

James Roughley, Danielle City Oswald, Patti Shaugnessy and 7 others like this.



Engagement Highlights

- 35 residents attended the two open houses
- 50 survey responses were received

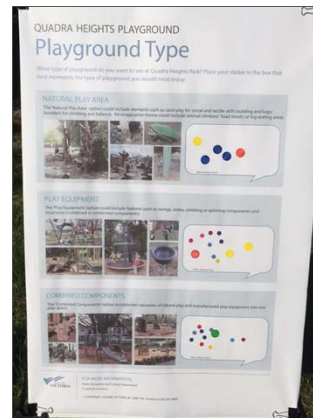

What We Heard

Key Themes: Play Features

- Combination of natural play areas and manufactured play equipment was preferred
- Swings were most popular type of playground equipment followed by playhouse/social/imaginative elements, climbing features, spinning features and natural play
- Existing merry-go-round seen as a unique feature
- Interest in reducing amount of sand, with support for keeping a small sand play area
- Ziplines and waterparks were suggested



What We Heard

Key Themes: Other Park Amenities

- Better lighting was requested
- More picnic tables and benches
- Dogs in Parks:
 - Requests for clearer bylaw signage
 - Requests for fenced area
 - Requests for dog bag dispenser



Conceptual Plan

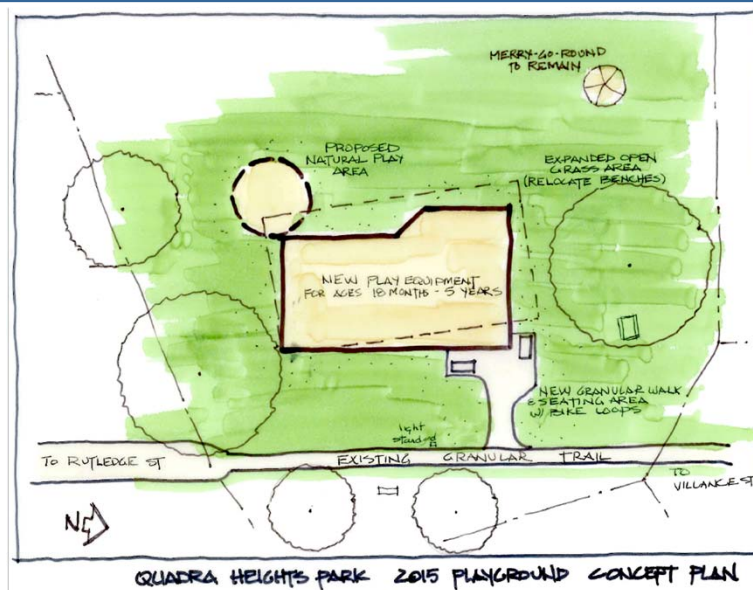

Next Steps

- Manufactured play equipment will be selected through the City of Victoria purchasing process. A tender process will be initiated in early June and the results of the public engagement will be considered in selecting the successful bid.
- A budget request of \$100,000 for the play area and park upgrade has been approved in the 2015 Financial Plan.
- Construction would commence in late summer and is expected to take eight weeks to complete.



Recommendation

- That Council receive this report for information

