

Site Plan

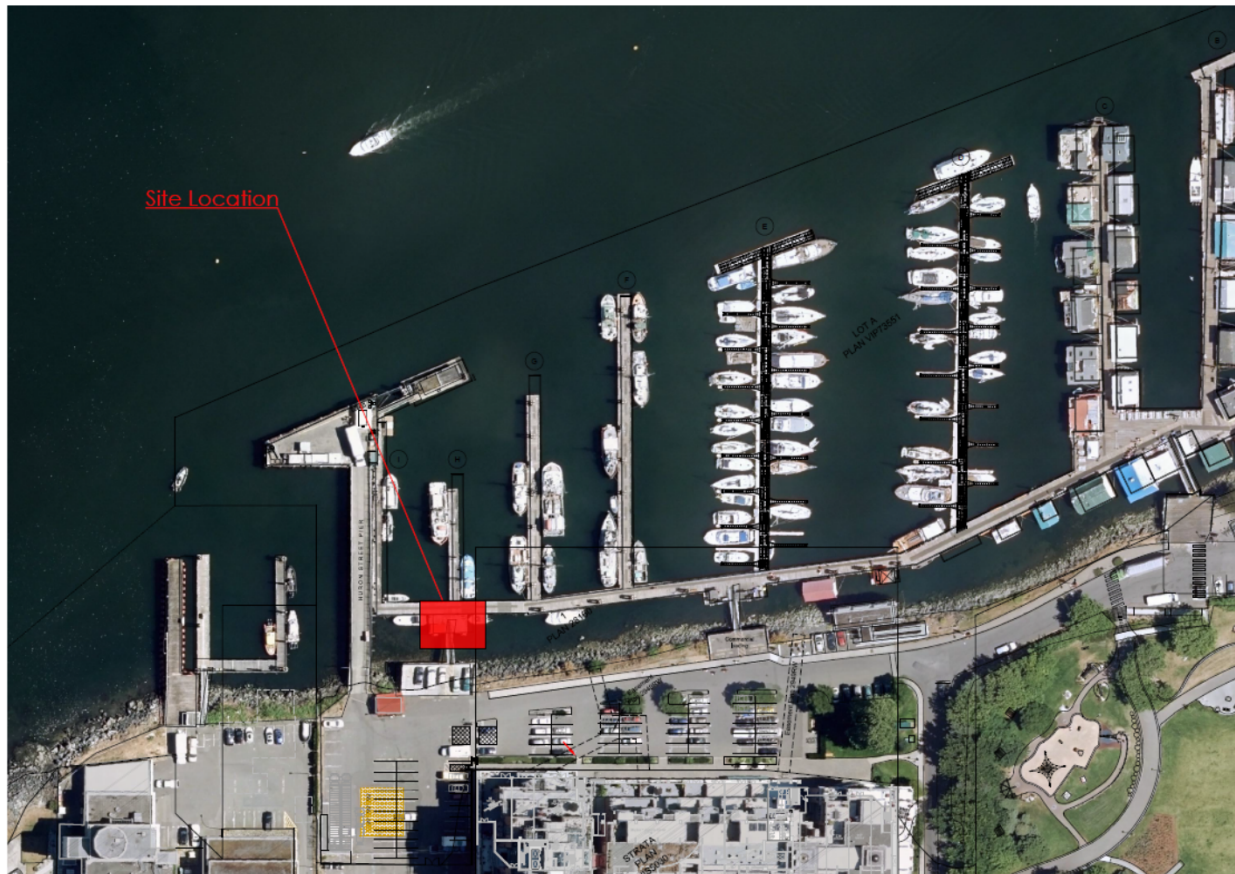

Location of Proposed Workshop Building at Fisherman's Wharf

Photographs Showing Existing Area

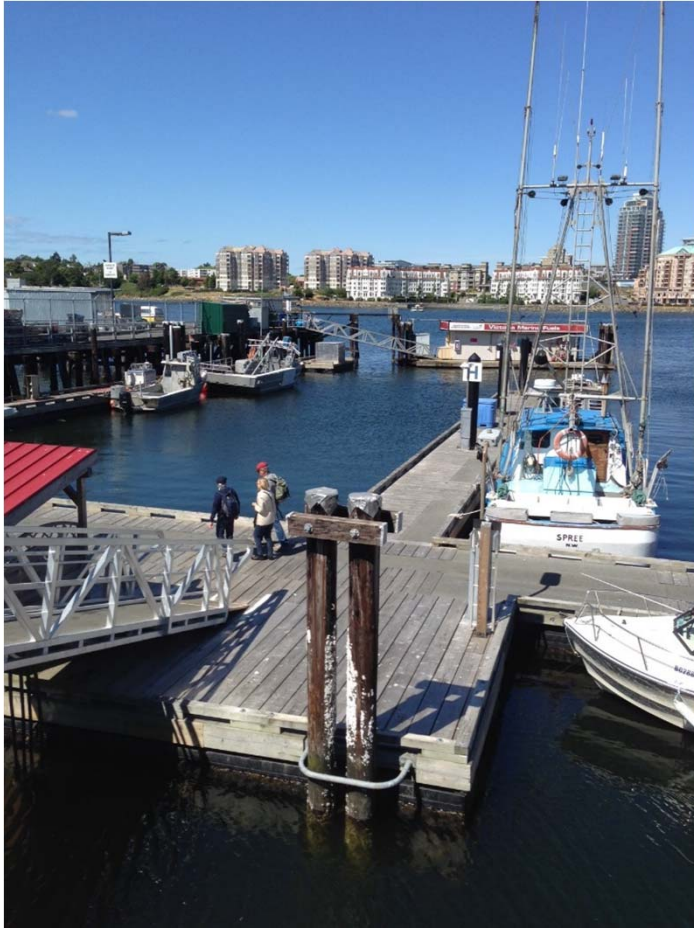

Photograph Looking North

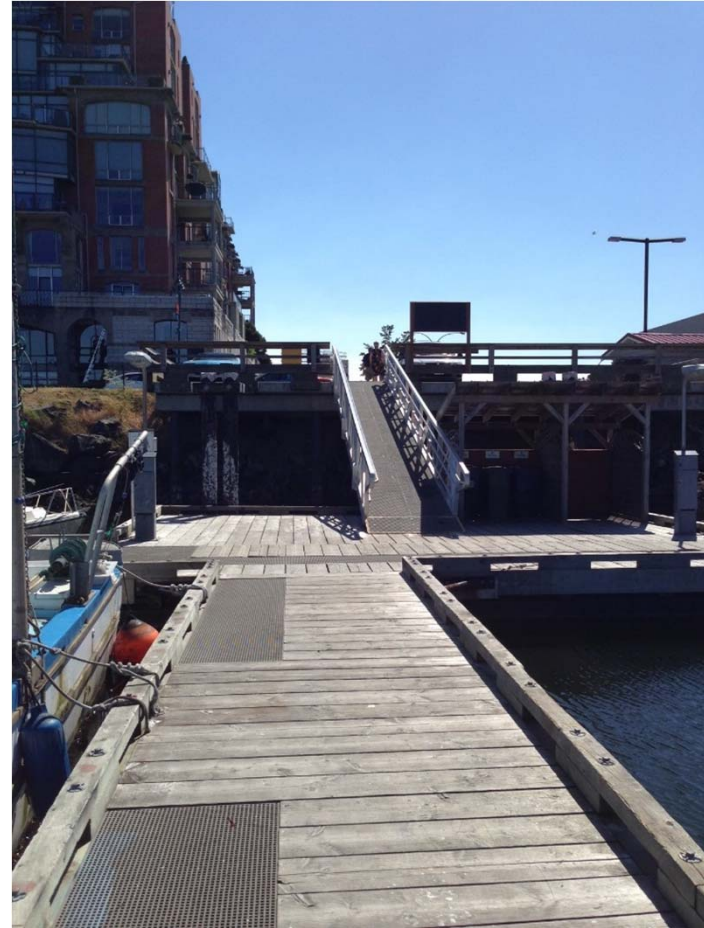

Photograph Looking South

Streetscape Elevation Plan

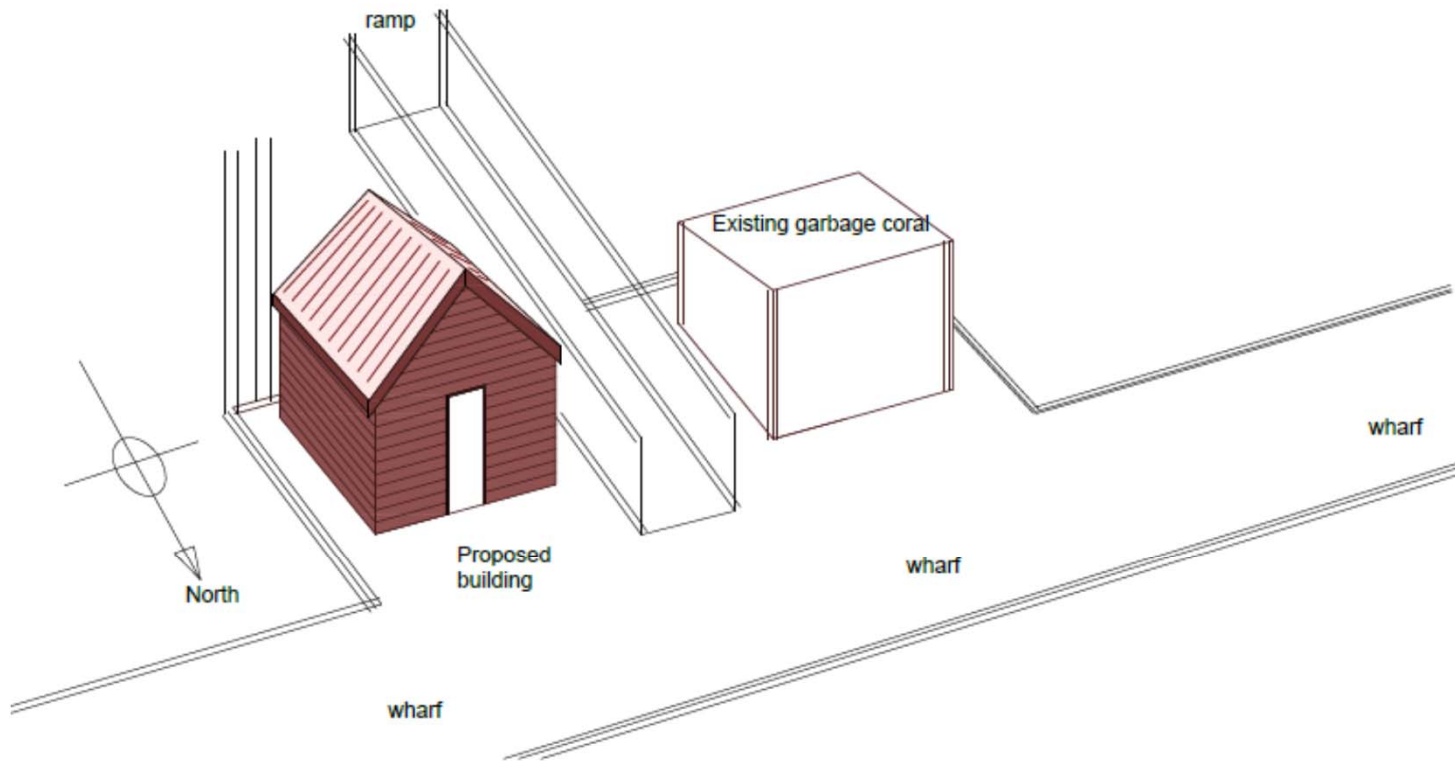
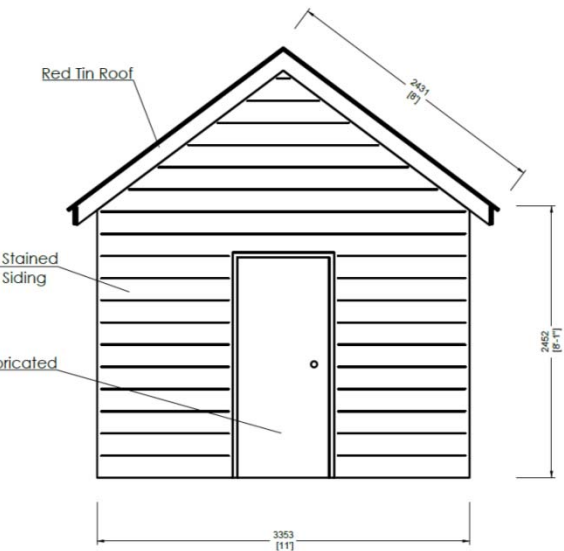
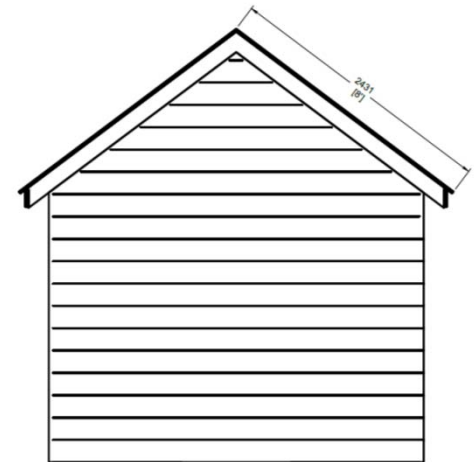

Image Showing Proposed Workshop Building and Adjacent Buildings at Fisherman's Wharf

Elevation Plans



Looking South



Looking North

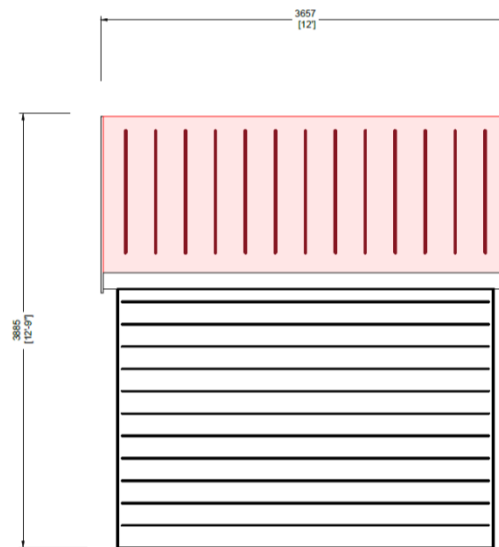

Looking East and West

Colours and Material Samples



Brown stained wood siding



Red Tin Roof

Floor Plan

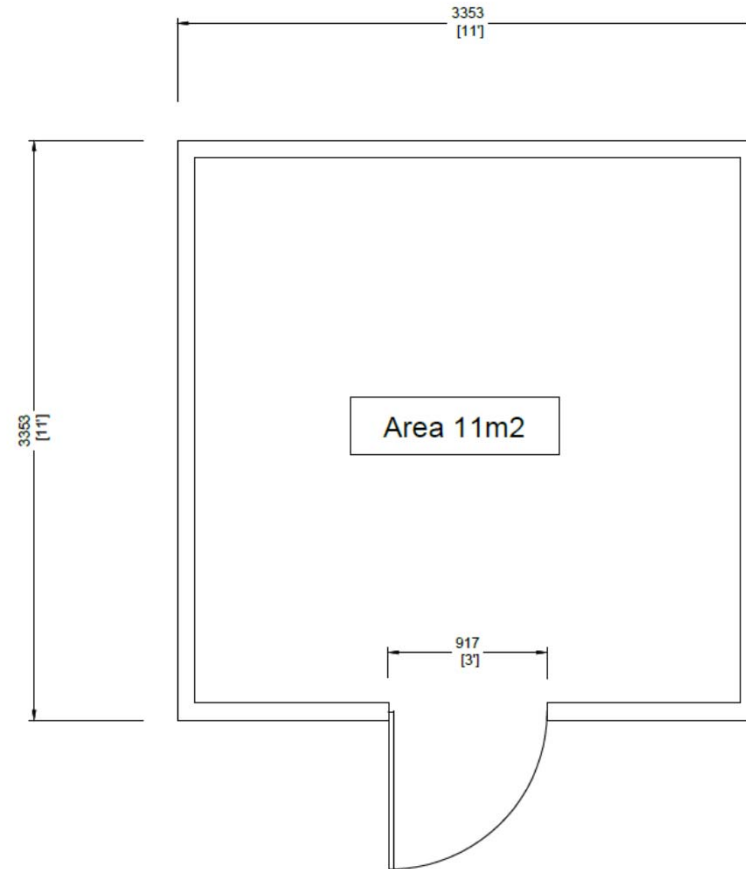

The proposed building is to provide secure space and storage for the GVHA maintenance team tools and service supplies to help maintain the public use of Fisherman's Wharf.

Perspective Drawing

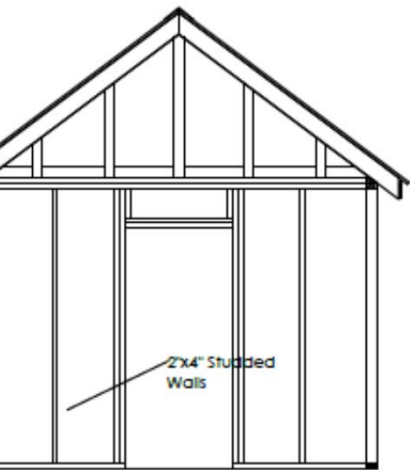
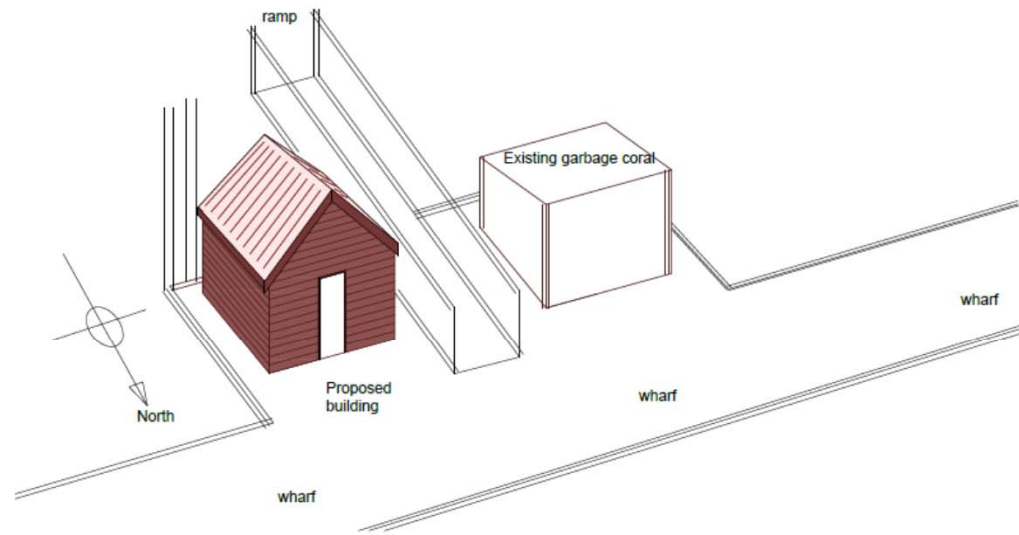

Looking South

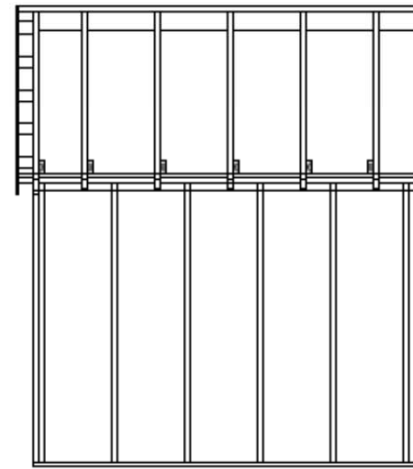

Looking East and West

Context Plan

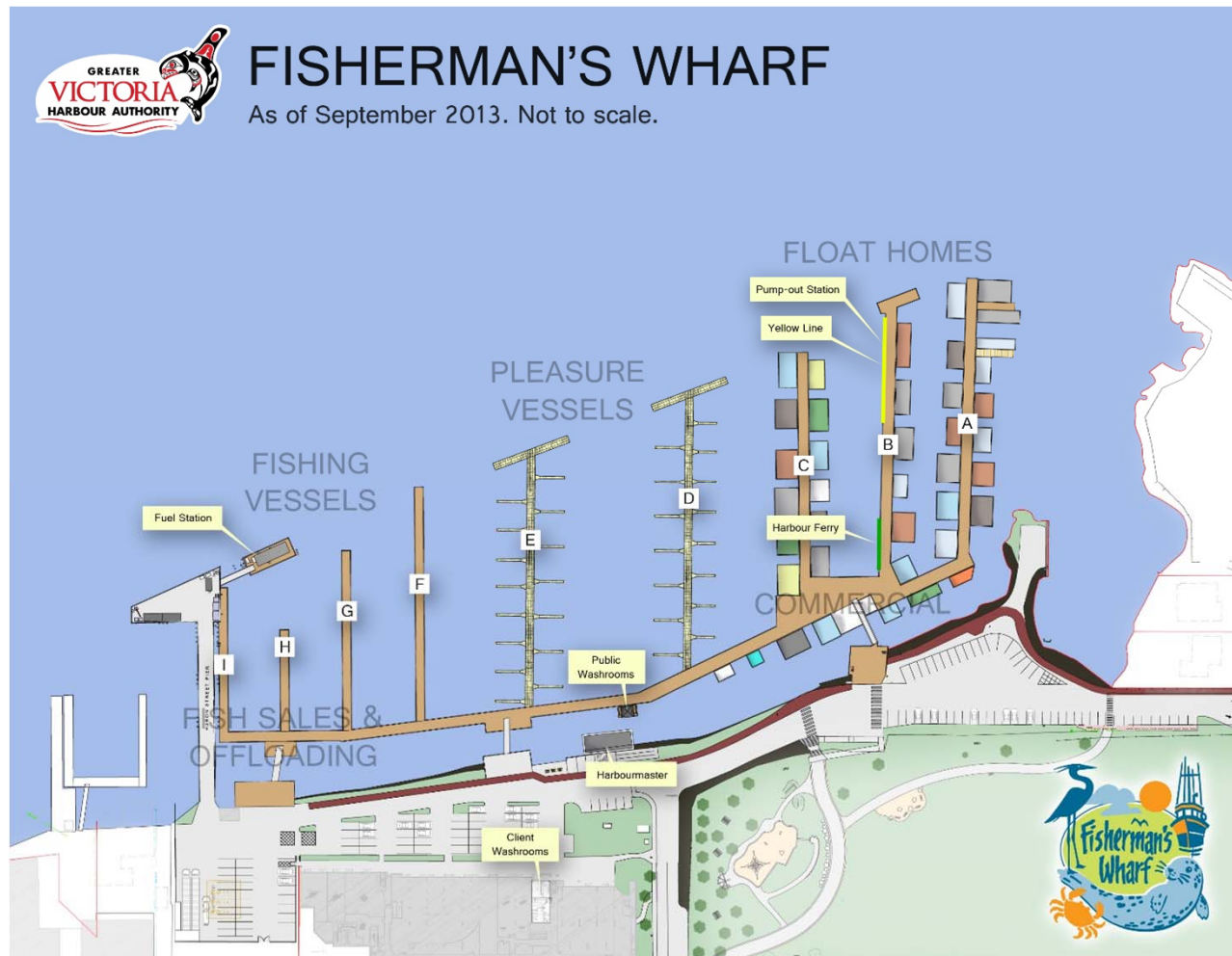

Fisherman's Wharf Map