

A BYLAW OF THE CITY OF VICTORIA

The purposes of this Bylaw are to amend the Zoning Regulation Bylaw by creating the M-1C Zone, Limited Light Industrial (Cannabis) District, and to rezone land known as 2018-2030 Douglas Street and 649 Pembroke Street from the M-1 Zone, Limited Light Industrial District to the M-1C Zone, Limited Light Industrial (Cannabis) District.

The Council of The Corporation of the City of Victoria enacts the following provisions:

- 1 This Bylaw may be cited as the “ZONING REGULATION BYLAW, AMENDMENT BYLAW (NO. 1118)”.
- 2 Bylaw No. 80-159, the Zoning Regulation Bylaw, is amended in the Table of Contents of Schedule “B” under the caption PART 7 – INDUSTRIAL AND SERVICE ZONES by adding the following words:

“7.57 M-1C, Limited Light Industrial (Cannabis) District”
- 3 The Zoning Regulation Bylaw is also amended by adding to Schedule B after Part 7.56 the provisions contained in Schedule 1 of this Bylaw.
- 4 The land known as 2018-2030 Douglas Street and 649 Pembroke Street, legally described as Lot A, Lots 878, 881, 882, and 883, Victoria City, Plan 39860 and shown hatched on the attached map, is removed from the M-1 Zone, Limited Light Industrial District, and placed in the M-1C Zone, Limited Light Industrial (Cannabis) District.

READ A FIRST TIME the	14th	day of	December	2017
READ A SECOND TIME the	14th	day of	December	2017
Public hearing held on the		day of		2018
READ A THIRD TIME the		day of		2018
ADOPTED on the		day of		2018

CITY CLERK

MAYOR

**PART 7.57 – M-1C ZONE, LIMITED LIGHT INDUSTRIAL (CANNABIS)
DISTRICT**

7.57.1 Permitted Uses in this Zone

The following uses are the only uses permitted in this Zone:

- a. Uses permitted in the M-1 Zone, Limited Light Industrial District; and
- b. Storefront cannabis retailer provided that only one storefront cannabis retailer is permitted to operate on a single lot.

7.57.2 Size & Location of Uses

A storefront cannabis retailer must:

- a. not occupy more than 72m²; and
- b. be located on the ground floor.

7.57.3 General Regulations

- a. Subject to the regulations in this Part 7.57, the regulations in the M-1 Zone, Limited Light Industrial District apply in this Zone.

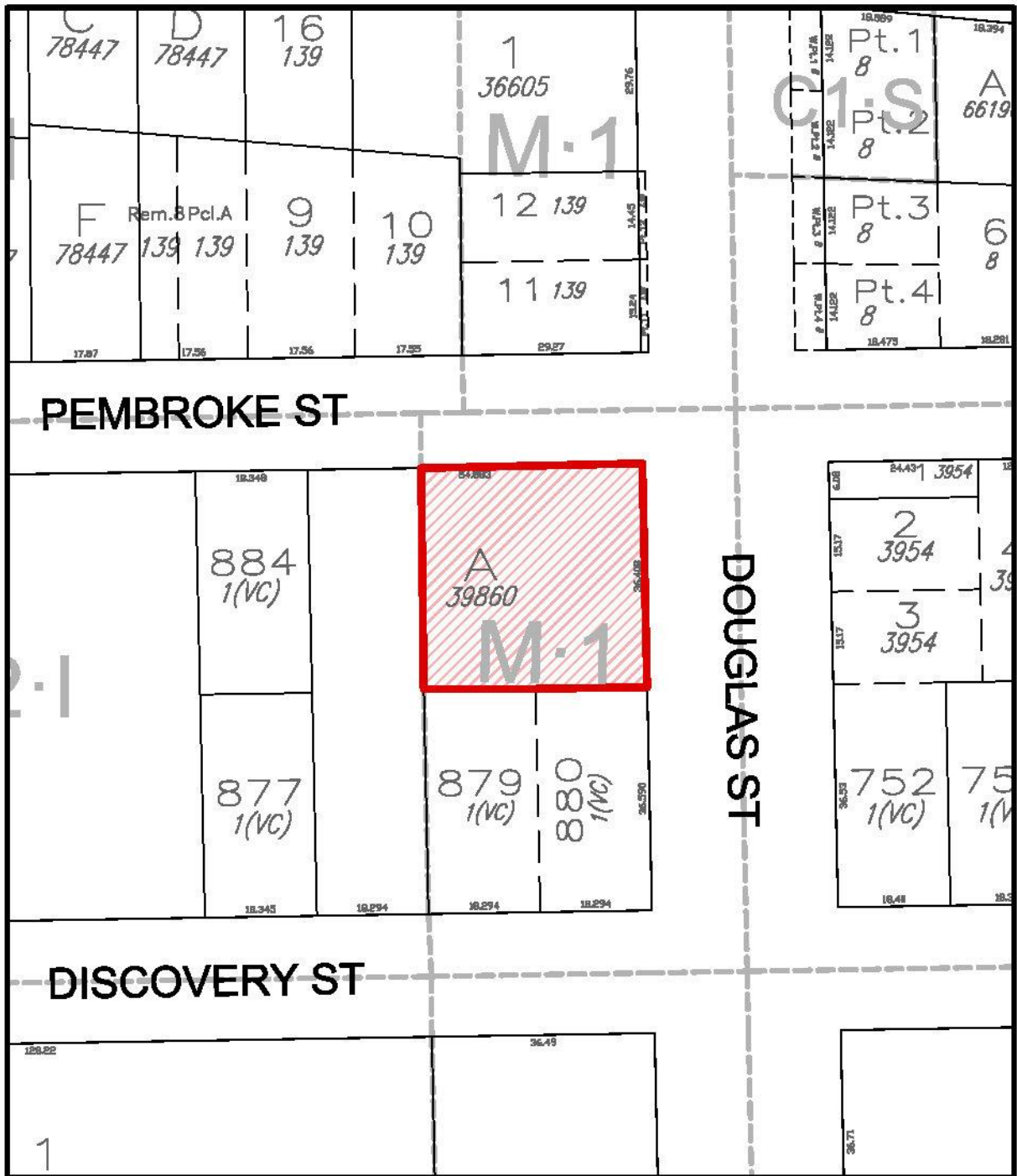

202 Douglas Street
Rezoning No.00581

