

NO. 16-052

A BYLAW OF THE CITY OF VICTORIA

The purposes of this Bylaw are to amend the Zoning Regulation Bylaw to rezone land known as 155 Linden Avenue from the R1-B Zone, Single Family Dwelling District to the R1-B-GS Zone, Single Family Dwelling with Garden Suite District.

The Council of The Corporation of the City of Victoria enacts the following provisions:

- 1 This Bylaw may be cited as the “ZONING REGULATION BYLAW, AMENDMENT BYLAW (NO. 1068)”.
- 2 The land known as 155 Linden Avenue, legally described as Lot 26, Fairfield Farm Estate, Victoria City, Plan 958 and shown hatched on the map attached to and forming part of this Bylaw as Appendix 1, is removed from the R1-B Zone, Single Family Dwelling District, and placed in the R1-B-GS Zone, Single Family Dwelling with Garden Suite District.

READ A FIRST TIME the **23rd** day of **June** 2016

READ A SECOND TIME the **23rd** day of **June** 2016

Public hearing held on the day of 2016

READ A THIRD TIME the day of 2016

ADOPTED on the day of 2016

CITY CLERK

MAYOR

Appendix 1 to Bylaw No. 16-052

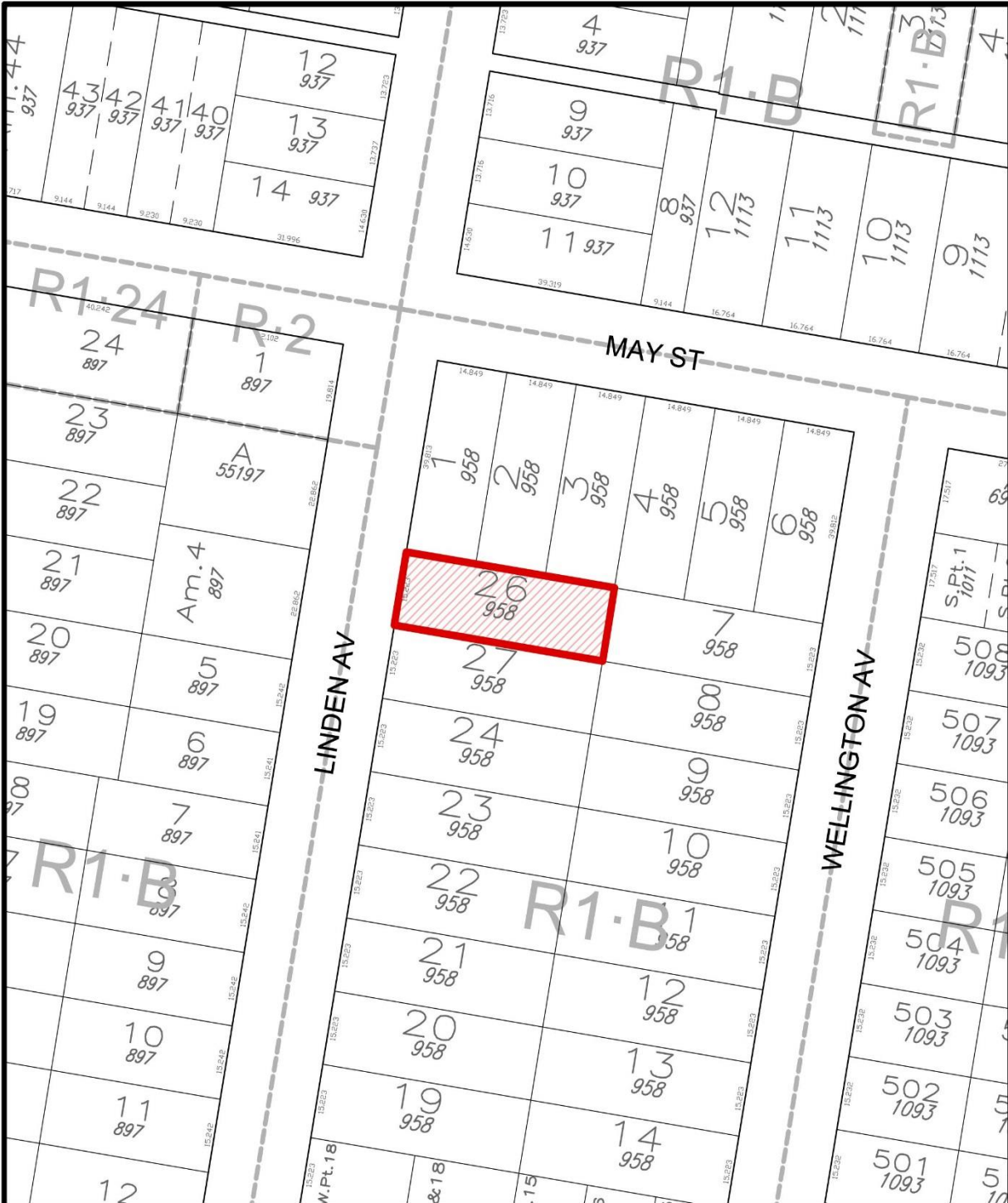

155 Linden Avenue
Rezoning No.00507

